

Quick Start Guide

Canon GL2 Video Camera



Initial Setup

- 1 Remove lens cap on front of camera
- 2 Attach battery pack to rear of camera by extending the viewfinder, rotating it upwards, and sliding the pack into place
- 3 Insert miniDV tape by sliding the OPEN/EJECT button forward, placing tape in compartment, pressing the PUSH mark until it clicks, and closing the cover



To Begin Recording

- 4 Slide the POWER switch to CAMERA on the top left side of the camera
- 5 Slide the TAPE/CARD switch to TAPE near the grip on the right side



- 6 Turn the standby lever to **STANDBY**



- 7 Open the LCD screen by pressing the OPEN button and rotating it outward. If you prefer, you can also use the camera's Viewfinder instead.



- 8 Put the camera in **EASY** mode by sliding the program selector to the left. This will allow you to point and shoot without making any manual adjustments.



For all other recording modes, slide the program selector to **P**. Next, push in on the **Select Dial** and choose the mode you prefer.



AUTO - This is the same as Easy mode, except that you now have the option of using any of the camcorder's manual options.

MANUAL - This allows you to freely adjust any of the camera's audio or visual settings as you like.

For a more detailed description of all the camera's possible settings, please consult the full Instruction Manual.

- 9 Press the **START/STOP** button to begin recording. Press the **START/STOP** button again to pause the recording. You can stop and restart as often as you like.



Quick Start Guide

Canon GL2 Video Camera



Additional Features

● Shotgun microphone

The shotgun mic will typically provide better sound quality for your recording. To use it, slide the mic onto the accessory shoe and tighten it with the shoe lock. Then select one of the following modes:

Shotgun: Best for recording clear sound from the front

Stereo 1: For recording sound from the front and surrounding area

Stereo 2: For recording surrounding sound in a wider area than Stereo 1

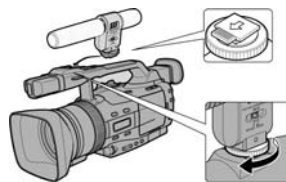

● Zoom

To zoom in and out while recording, use the **W** and **T** controls. **T** (telephoto) zooms in. **W** (wide-angle) zooms out.

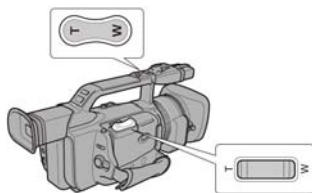

● Charging the battery

To charge the camera battery - place it in the power adapter, connect the power cord to the adapter, and plug it into an electrical outlet. When the power light glows steadily, the pack is fully charged.



● Running on AC power

To run the camera on AC power - 1) connect the power cord to the adapter 2) plug the adapter into an outlet 3) connect the DC coupler to the adapter and 4) attach the DC coupler to the camera

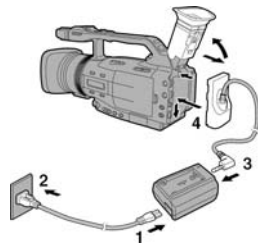

● To playback your recording:

1. Slide the power switch to **PLAY (VCR)**
2. Load the cassette tape
3. Open cover on top of the handle, and use the controls

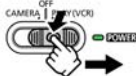

● To playback on a TV monitor:

Follow the 3 steps above, then connect the RCA cable to the **A/V** input on the back of the camera, and the audio/video inputs on your TV.

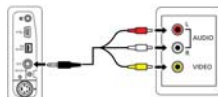

If you encounter any problems, please give us a call at 1-877-633-8866 or consult the full instruction manual included in this package.